

CoolCollect Cooler 3D

Technical Data

Outer dimension: (w x d x h)	512 x 710 x 2265 mm
Inner dimension: (w x d x h)	400 x 490-518x 450-542 mm
Volume:	360 l
Weight:	120 kg (net.)
Shelf dimension: (w x d)	406x381 mm (safety pool)
Locks:	Electromechanical locks
Compressor:	Embraco EMX3118Y
Refrigerant:	R600a, 102 g
Defrosting:	automatic
Power input:	300 W (1.3A)
Fuse:	10 A
Energy consumption:	4.0 kWh /24 h
Running time:	13 h/d
Temperature range:	-1...+5 °C
Noise level (db(A)):	<56
Color:	White RAL 9003 or Gray RAL 7015
Power cord length:	1.9 m
Climate class:	3
Operating conditions:	+10.... +25 °C / 60 % RH

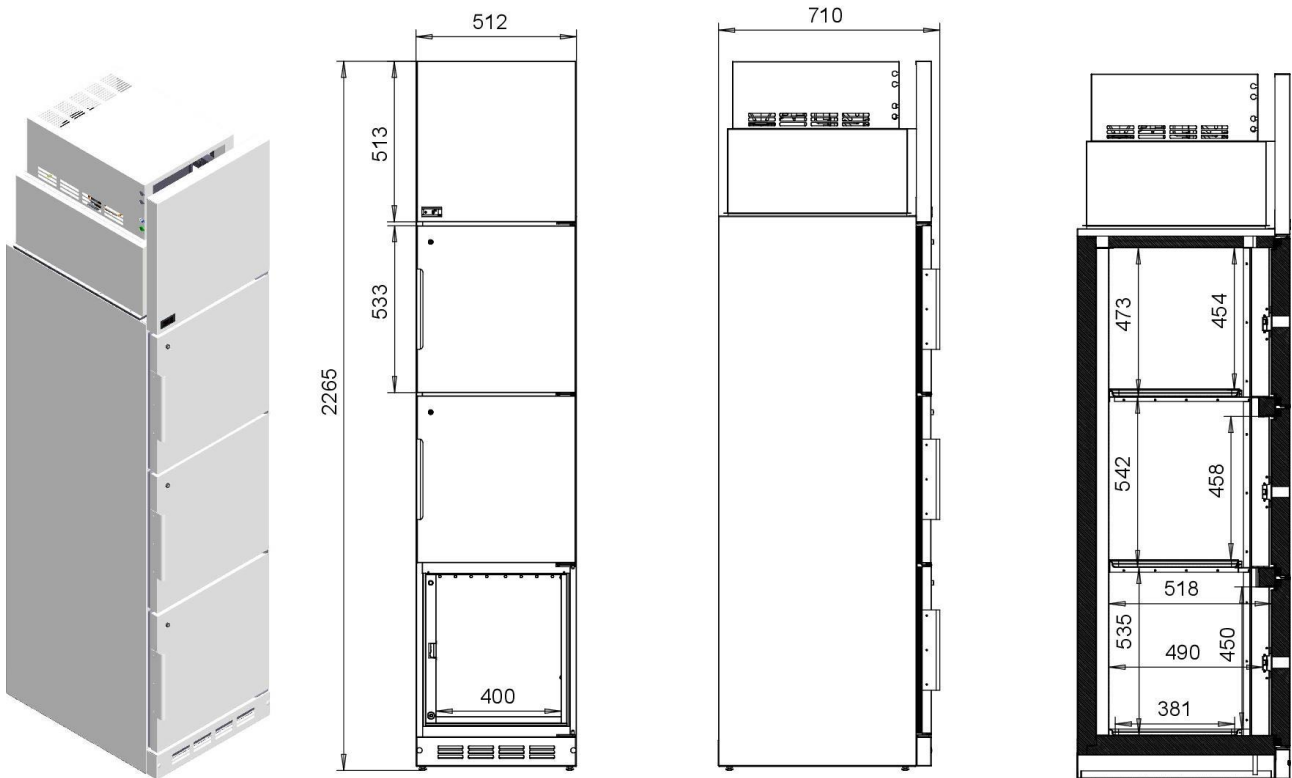

Manufacturer

Coolcenter Forssa Oy
Sipilänkatu 11
30100 Forssa, FINLAND
www.coolcenter.fi