

# CoolCollect® Indoor MOD 8V2

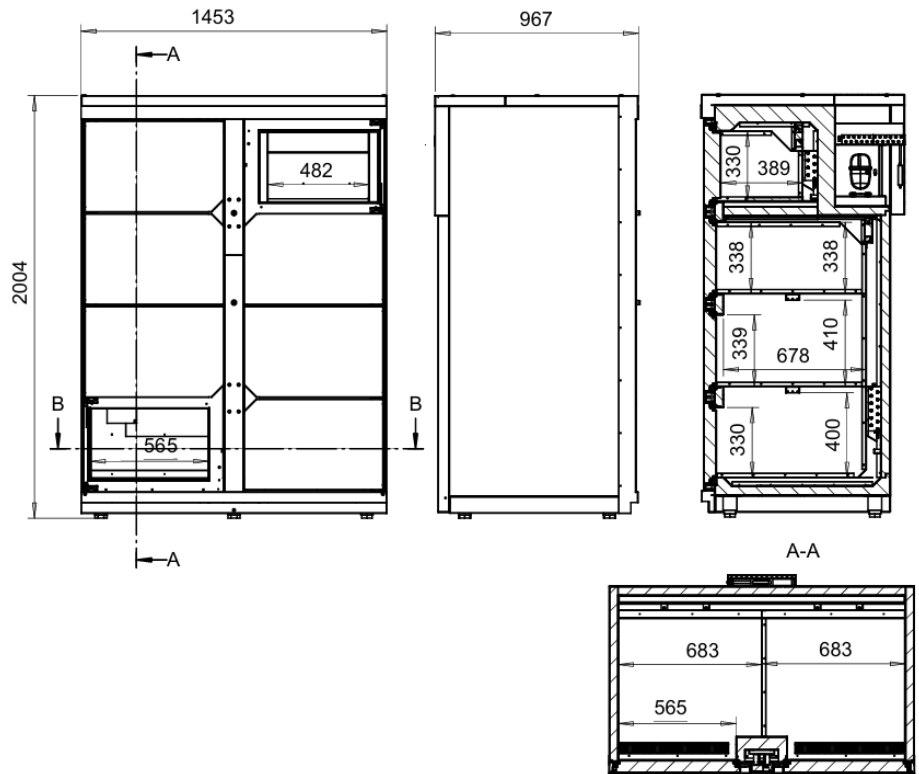
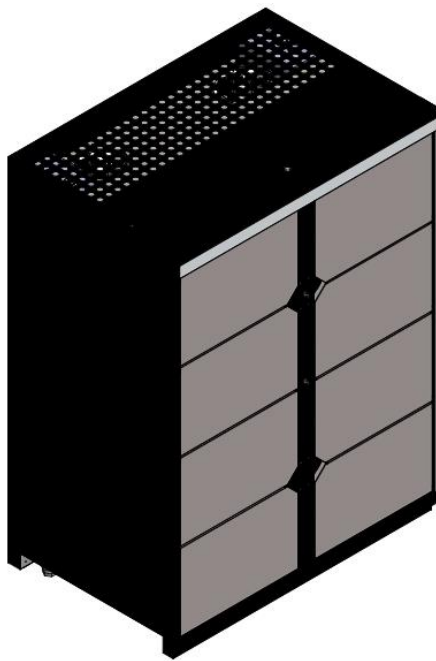

Design and Material		Dimensions		Cooling	
Doors and Type	8 Doors Hinged, Right handed 4 pcs Left handed 4 pcs	Outer dimensions mm (WxDxH)	1453 x 967 x 2004	Type of Controller	Electronic
Doors reversible	No	Inner dimensions mm (WxDxH)	cooler locker 683 x 678 x 338-410 freezer locker 482 x 389 x 330	Type of Cooling	Fan assisted
Self-closing doors	Yes	Size of door opening mm (WxH)	cooler locker 565 x 330-339 freezer locker 482 x 330	Type of Defrost	cooler Automatic freezer Hot gas
Door Locks	solenoid (UPS recommended)	Packing dimensions mm (WxDxH)	1465 x 979 x 2004	Refrigerant	R290a
Max load on Shelves	40 kg	Volume net	1310 l	Refrigerant charge	cooler 150 g freezer 150 g
Feet / Legs	5 adjustable	Locker quantity	8 cooler 6 pcs freezer 2 pcs	Thermometer	Digital
Castors	No	Locker volume net	cooler 6 x 170 l freezer 2 x 145 l	Visible temperature	No, temperature displays visible by opening freezer locker
Interior light	No	Loading volume	12 cardboard boxes, 2 boxes per cooler locker (box size W300-350 D500 H260) + 2 spacious freezer lockers		
Handle	Integrated				
Exterior Finish	Frame Black RAL9005 FT Doors Grey RAL7015 FT Structural painting				
Interior Finish	White RAL9003				
Measures and Content		Power & Consumption		Accessories	
Temperature range	cooler +4...+8°C freezer -18...-20°C	Energy Consumption	N/A	Stone plates onto shelves in freezer lockers	included, 2 pcs
Climate class	3	Annual Energy Consumption	- kWh/year	Ambient room temperature sensor	optional
Operating conditions	max. +25°C / 60 % RH	Voltage / Frequency	230 V / 50 Hz		
Weight net / gross	410 / 413 kg	Noise Level	- dB		
		Power input	2040 W		
		Fuse	16A		